

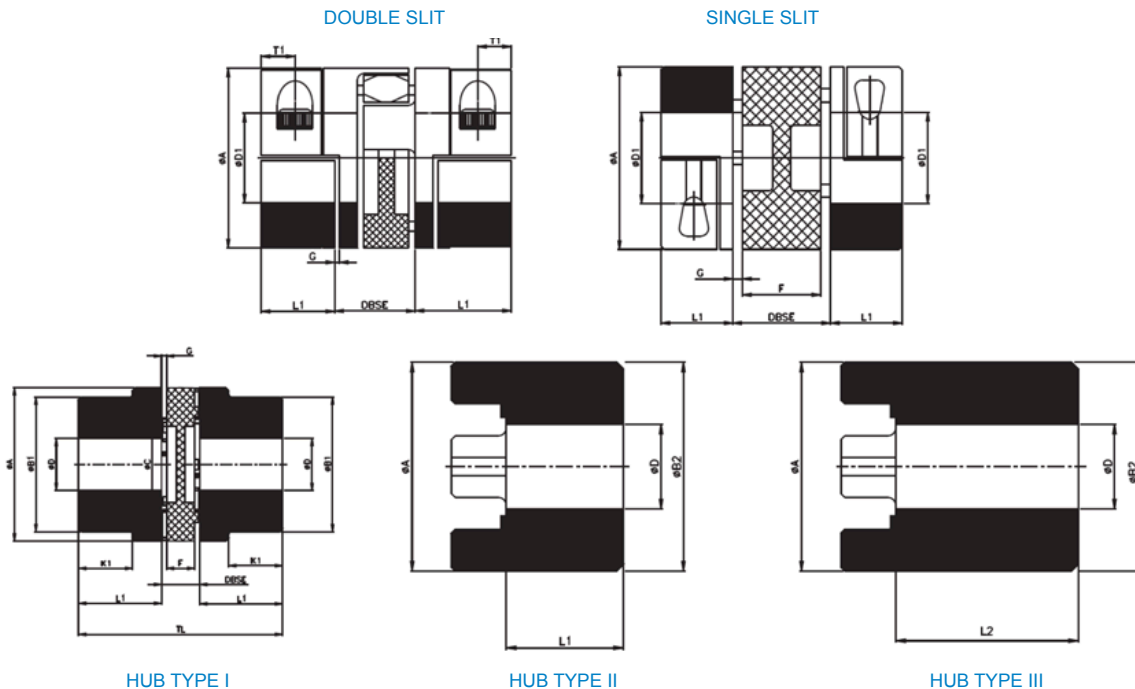

# Curve-Flex Type RJB - Jaw-Flex Couplings

## Features

- Backlash Free
- Torsionally Stiff
- Vibration - Reducing
- Axial Plug-in
- Maintenance Free
- Electrically insulating
- Fail Safe
- Coupling for Machine Tools, Automation, Power Transmission, Medical Technology, Packing Technology and Servo Motor Application
- Ambient temp. from -40°C to 120°C possible (dependent on spider)



## Technical Data

Coupling SIZE	Hub TYPE	kW at 100 RPM			Torque Nm			Max. Speed RPM	BORE ØD			DIMENSIONS										# ASSEMBLY			
		Gray	Blue	Light Ivory	Gray	Blue	Light Ivory		PB	MIN.	MAX.	ØA	ØB1	ØB2	ØC	DBSE (MIN.)	F	L1	L2	G	TL	K1	K2	Weight (kg.)	M.I. (kg-m <sup>2</sup> )
24	I	0.35	0.65	0.80	33	62	76	10600	-	9	24	56	40	-	27	18	14	30	-	2	78	24	-	0.24	9 X 10 <sup>-5</sup>
	22									28	-		56	30				-	78		24	-	0.34	19 X 10 <sup>-5</sup>	
28	I	0.95	1.75	2.07	91	167	198	8500	-	10	28	66	48	-	30	20	15	35	-	2.5	90	28	-	0.39	20 X 10 <sup>-5</sup>
	28									38	-		66	35				-	90		28	-	0.54	42 X 10 <sup>-5</sup>	
38	I	1.90	3.47	4.21	182	332	402	7100	10	12	40	80	66	-	38	24	18	45	-	3	114	37	-	2.00	1.85 X 10 <sup>-3</sup>
	12									48	-		78	45				-	114		37	-	2.40	2.45 X 10 <sup>-3</sup>	
	12									48	-		78	-				70	164		-	62	3.60	3.72 X 10 <sup>-3</sup>	
42	I	2.65	4.99	5.86	253	477	560	6000	12	14	45	95	75	-	46	26	20	50	-	3	126	40	-	3.20	4.1 X 10 <sup>-3</sup>
	* II									14	50		-	94				50	-		126	40	-	3.54	5.21 X 10 <sup>-3</sup>
	II									14	55		-	94				50	-		126	40	-	3.80	5.9 X 10 <sup>-3</sup>
	III									14	55		-	94				-	75		176	-	65	5.50	8.54 X 10 <sup>-3</sup>
48	I	3.10	5.49	6.98	296	524	667	5600	13	15	52	105	85	-	51	28	21	56	-	3.5	140	45	-	4.40	6.2 X 10 <sup>-3</sup>
	* II									15	55		-	85				56	-		140	45	-	4.76	8.43 X 10 <sup>-3</sup>
	II									15	62		-	104				56	-		140	45	-	5.20	9.6 X 10 <sup>-3</sup>
	III									15	62		-	104				-	80		188	-	69	4.20	13.4 X 10 <sup>-3</sup>

- 1) # Weight & moment of inertia (M.I) of coupling assembly refer to maximum finish bore without keyway.
- 2) All dimensions are in mm.
- 3) Spider colour - Blue, Gray, Light Ivory
- 4) \* Coupling type II (with slit)
- 5) For vertical installation contact RATHI.
- 6) Consult for Max Bore with Square Key.