



Tyre Couplings - Type RTP / RTPS



Features

Torque transmission is by shear
Tyre is split into two halves, each bonded to a metal bracket
Each tyre is bolted radially to hubs mounted on shafts
Special material with high durability, strength & fatigue resistance

Benefits

Easy maintenance, as assembly & disassembly does not require any special skills
Hubs may be fitted with different orientations to achieve different DBSE
Higher misalignment capability
Taper lock bushes may be fitted if required

Applications

General Applications - Agitators, Blowers, Conveyors, Cranes, Pumps etc.
Industry Applications - Cement, Food, Rubber, Steel, Paper, Power Plants etc.

RTP

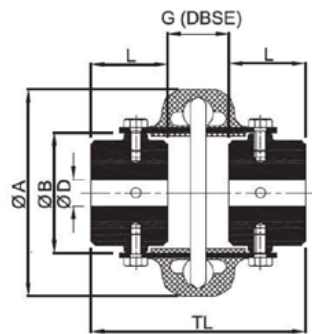

STANDARD TYPE

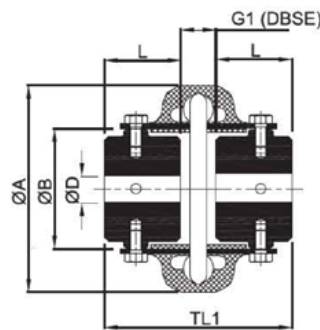

HUB REVERSED TYPE

RTPS

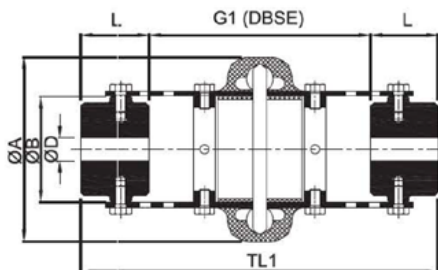

STANDARD TYPE

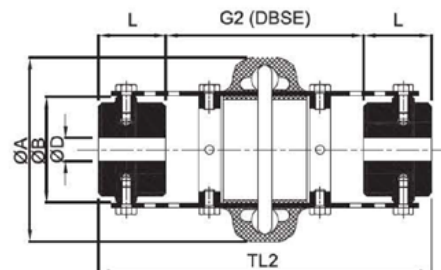

HUB REVERSED TYPE



Tyre Couplings - Type RTP / RTPS

Technical Data RTP

Size	Power kW at 100 rpm	Torque Nm (TK _n)	Speed rpm (Max)	Bore		Dimensions							Weight Kg (Max Bore)
				ØD (Pilot)	ØD (Max)	ØA	ØB	L	DBSE		Total Length		
									Std. Hub	Reserve Hub	Std. Hub	Reserve Hub	
									G	G1	TL	TL1	
RTP-90	0.23	22	7500	13	28	90	47	24	46	36	94	84	0.65
RTP-103	0.45	43	7500	13	36	103	59	38	46	8	122	84	1
RTP-117	0.66	63	7500	13	42	117	66	38	46	8	122	84	1.8
RTP-138	1.15	110	7500	13	48	138	80	44	59	8	147	96	3
RTP-163	1.89	181	7500	13	55	163	93	44	59	8	147	96	4.4
RTP-185	2.72	260	6600	21	60	185	114	50	65	13	165	113	5.65
RTP-211	4.34	414	5800	21	78	211	138	58	69	12	185	128	11.3
RTP-319	14.99	1432	3800	31	115	319	222	82	97	8	261	172	35.1
RTP-357	26.50	2531	3600	31	123	357	235	85	109	18	279	188	40.4

Technical Data RTPS

Size	kW at 100 rpm	Torque Nm (TK _n)	Speed rpm (Max)	Bore		Dimensions							Weight Kg (Max Bore)
				ØD (Pilot)	ØD (Max)	ØA	ØB	L	DBSE		Total Length		
									Std. Hub	Reserve Hub	Std. Hub	Reserve Hub	
									G1	G2	TL1	TL2	
RTPS-103-R	0.45	43	7500	13	36	103	59	38	100,140	55,95	176,216	131,171	1.3
RTPS-117-R	0.66	63	7500	13	42	117	66	38	100,140	55,95	176,216	131,171	2.0
RTPS-138-R	1.15	110	7500	13	48	138	80	44	100,140	49,89	188,228	137,177	3.5
RTPS-163-R	1.89	181	7500	13	55	163	93	44	100,140	49,89	188,228	137,177	4.8
RTPS-211	4.34	414	5800	21	78	211	138	58	140,180	80,123	256,296	196,239	11.7
RTPS-319	14.99	1432	3800	31	115	319	222	82	180,250	92,162	344,414	256,326	36.3
RTPS-357	26.50	2531	3600	31	123	357	235	85	180,250	88,159	350,420	258,329	41.6

The "R" in sizes RTPS-103 to RTPS-163 designates that the coupling is provided with high speed rings. Rings are standard for these sizes and optional for others. Consult for Max Bore with Square Key.